



WSV WaterStop Valve
for **SCALEMASTER®** Nozzles



WSV Water Stop Valve – features and benefits

The problem

The use of low water pressure pre-fill function is a standard feature in a modern descaling system in order to eliminate hydraulic shock (water hammers) when initiating high pressure spraying through an open header.

However, the low pressure water continuously charged through the open descaling nozzles can cause undesired metallurgical effects due to the uncontrolled cooling especially when rolling critical plates (API-pipe or stainless steel grades) during a »Thermo Mechanical Control Process« (TMCP).

The solution

The installation of the new Lechler WSV Water Stop Valve for SCALEMASTER® descaling nozzles in front of every nozzle prevents a water flow through the nozzles below a water pressure of 10, respectively 5 bar.

The features

- The WSV is a check valve which includes the stabilizer
- Every WSV comes with a filter
- Material completely made from stainless steel
- Metallic sealing
- Piston hardened

The advantages and benefits

- No significant changes of nozzle spray characteristics (width, thickness, liquid distribution)
- No modifications of header required
- Available for nozzle series SCALEMASTER®, MiniSCALEMASTER®, SCALEMASTER® HP and MiniSCALEMASTER® HP
- Very large internal free passages for clogging free operation
- Simple design, all four components easy to replace
- Field Test approved
- Long service life



WSV Water Stop Valve

Technical Data

This page shows the components and basic technical data of the WSV Water Stop Valve. For further information please do not hesitate to contact us.

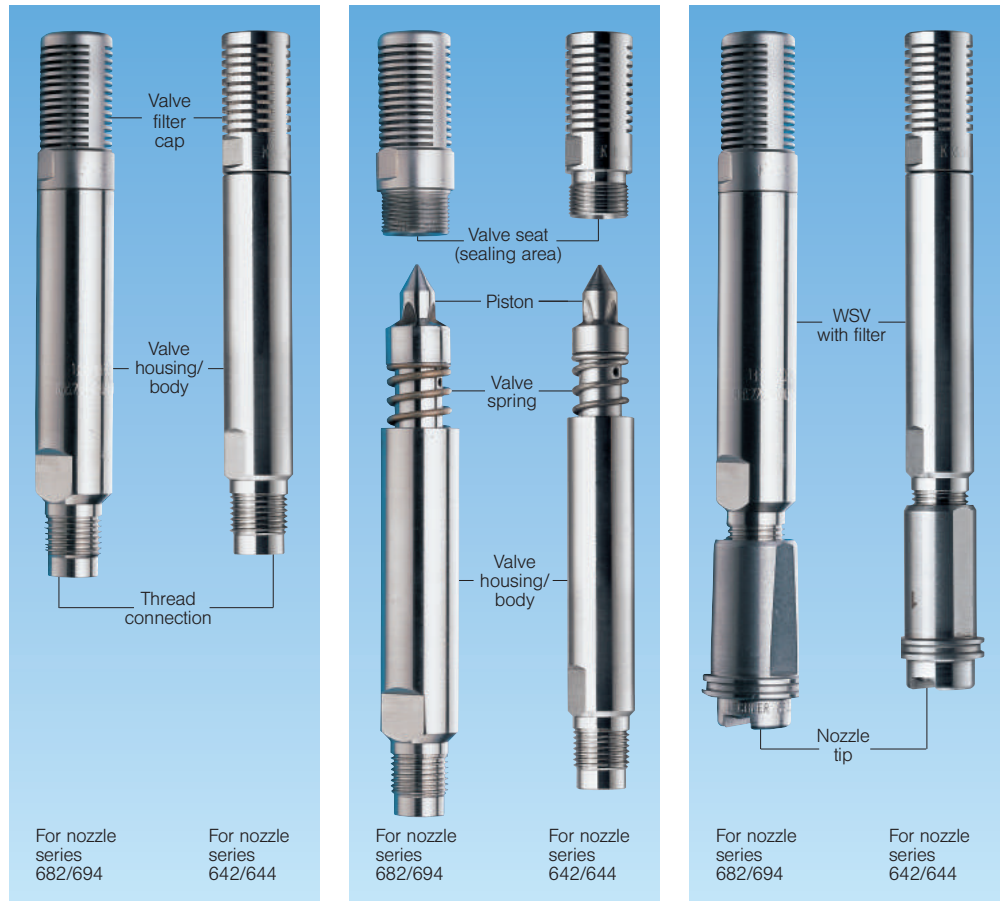

WSV Water Stop Valve

WSV Water Stop Valve, components

WSV Water Stop Valve, mounted with nozzle

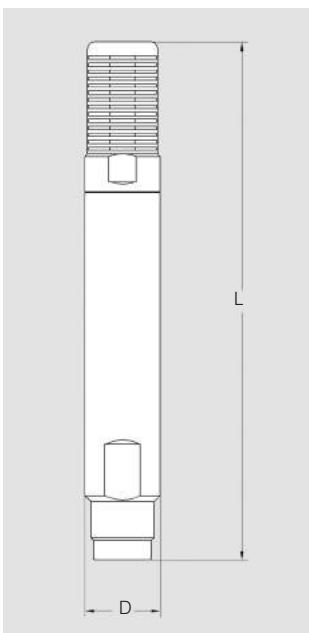

Technical Data

For use in combination with nozzle series	Ordering number	Opening pressure [bar]	Closing pressure [bar]	Filter slit width [mm]	L [mm]	D [mm]	G	Weight [g]
SCALEMASTER® 694	069.422.1E.01.00.0	8	5	1	148	21,5	M18x1	242
	069.422.1E.00.00.1	14	10	1	148	21,5	M18x1	242
SCALEMASTER® HP 682	068.220.1E.01.00.0	8	5	1	148	21,5	M16x1,5	242
	068.220.1E.00.00.1	14	10	1	148	21,5	M16x1,5	242
MiniSCALEMASTER® 644	064.423.1E.01.00.0	8	5	1	140	18,8	M16x1	176
	064.423.1E.00.00.0	14	10	1	140	18,8	M16x1	176
MiniSCALEMASTER® HP 642	064.223.1E.01.00.0	8	5	1	140	18,8	M16x1,5	176
	064.223.1E.00.00.0	14	10	1	140	18,8	M16x1,5	176

Materials

Component	Material
Valve filter cap	1.4435
Piston	1.4057
Valve spring	1.4310
Valve housing	1.4435

WSV Water Stop Valve Assembly with SCALEMASTER® nozzles



Lechler GmbH
Precision Nozzles · Nozzle Systems
P.O. Box 13 23
72544 Metzingen / Germany
Phone: +49 (0) 71 23 962-0
Fax: +49 (0) 71 23 962-333

E-Mail: info@lechler.de
Internet: www.lechler.de

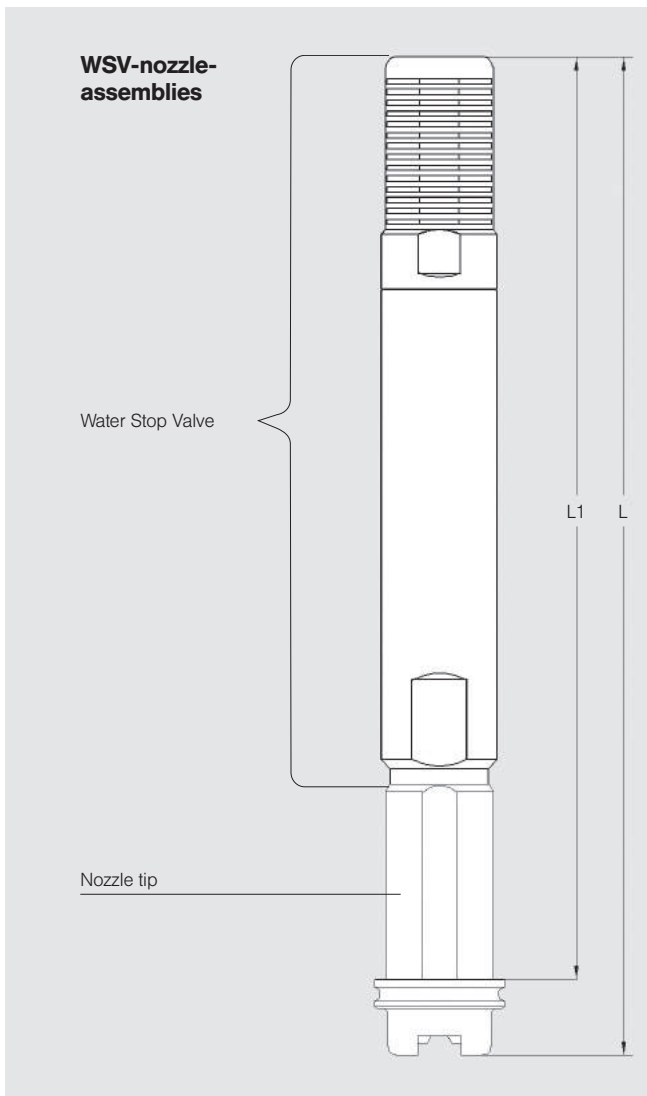

Nozzle series	WSV Ordering number	L [mm]	L1 [mm]
SCALEMASTER® 694	069.422.1E.01.00.0	170	156
	069.422.1E.00.00.1	170	156
SCALEMASTER® HP 682	068.220.1E.01.00.0	185	171
	068.220.1E.00.00.1	185	171
MiniSCALEMASTER® 644	064.423.1E.01.00.0	162	148
	064.423.1E.00.00.0	162	148
MiniSCALEMASTER® HP 642	064.223.1E.01.00.0	177	163
	064.223.1E.00.00.0	177	163

Belgium: Lechler S.A./N.V. · Avenue Mercatorlaan, 6 · 1300 Wavre · Phone: (10) 225022 · Fax: (10) 243901 · info@lechler.be
China: Lechler Intl. Trad. Co. Ltd. · Beijing Office · Rm. 1812 CTS Plaza · No.2 Bei San Huan Dong Lu · Phone: (86) 1064661986, Fax: (86) 1064660196 · info@lechler.com.cn
Finland: Lechler Oy · Kalliotie 2 · 04360 Tuusula · Phone: (358) 98709844 · Fax: (358) 98709847 · info@lechler.fi
France: Lechler France, S.A. · Bât. CAP2 B51 · 66-72, Rue Marceau · 93558 Montreuil cedex · Phone: (1) 49882600 · Fax: (1) 49882609 · info@lechler.fr
Great Britain: Lechler Ltd. · 1 Fell Street, Newhall · Sheffield, S9 2TP · Phone: (0114) 2492020 · Fax: (0114) 2493600 · info@lechler.com
India: Lechler (India) Pvt. Ltd. · Plot B-2 · Main Road · Wagle Industrial Estate · Thane (W) - 400604 · Phone: (22) 25811196 · Fax: (22) 25821262 · lechler@lechlerindia.com
Sweden: Lechler AB · Box 158 · 68324 Hagfors · Phone: (46) 56325570 · Fax: (46) 56325571 · info@lechler.se
Spain: Lechler S.A. · Avda. Pirineos 7 · Oficina B7, Edificio Inbisa I · 28700 San Sebastián de los Reyes, Madrid · Phone: (34) 916586346 · Fax: (34) 916586347 · info@lechler.es
USA: Lechler Inc. · 445 Kautz Road · St. Charles, IL. 60174 · Phone: (630) 377-6611 · Fax: (630) 377-6657 · metals@lechlerUSA.com