

High pressure flat fan nozzles

Series 602

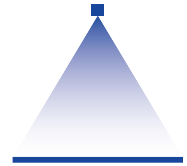

Features:

- Sharp, uniform flat fan spray
- Extremely narrow spray depth
- Housing: Stainless steel 303,
Insert: Hardened stainless steel 420F

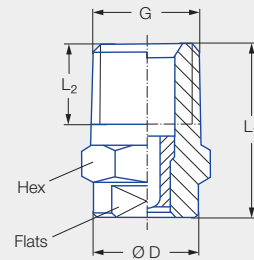

Applications:

- High pressure cleaning

Series 602

G	Dimensions [in]					Weight [lb]	p _{max} ¹ [psi]
	L ₁	L ₂	Ø D	Hex (mm)	Flats (mm)		
1/4 BSPT	0.87	0.39	0.51	14	10	.04	approx. 10,153
1/4 NPT	0.87	0.40	0.51	14	10	.04	approx. 10,153

¹ Applies only to operation at constant pressure.

International Code US gal/min. at 40 psi	Ordering number							Equivalent bore diameter A [in]	V̇ water [gal/min]								
	Series	Flow rate code				Mat. No. A3 Stainless steel 303/420F	Connection		p [psi]								
		Spray angle					1/4 BSPT		1/4 NPT	40	600	liters per minute 80 bar	1000	1500	2000	3000	4500
		20°	30°	45°	60°												
02	602	361	362	363	364	●	00	07	0.039	0.20	0.77	4.08	1.00	1.22	1.41	1.73	2.12
021	602	371	372	373	374	●	00	07	0.040	0.21	0.81	4.28	1.05	1.29	1.49	1.82	2.23
025	602	381	382	383	384	●	00	07	0.043	0.25	0.97	5.10	1.25	1.53	1.77	2.16	2.65
028	602	391	392	393	394	●	00	07	0.045	0.28	1.09	5.71	1.40	1.72	1.98	2.43	2.97
03	602	401	402	403	404	●	00	07	0.046	0.30	1.16	6.11	1.50	1.84	2.12	2.60	3.18
034	602	411	412	413	414	●	00	07	0.051	0.34	1.32	6.93	1.70	2.08	2.40	2.94	3.61
038	602	441	442	443		●	00	07	0.052	0.38	1.47	7.75	1.90	2.33	2.69	3.29	4.03
04	602	451	452	453	454	●	00	07	0.053	0.40	1.55	8.16	2.00	2.45	2.83	3.47	4.25
043	602	461	462			●	00	07	0.054	0.43	1.67	8.77	2.15	2.63	3.04	3.72	4.56
045	602	471	472	473	474	●	00	07	0.055	0.45	1.74	9.18	2.25	2.76	3.18	3.90	4.77
05	602	481	482	483	484	●	00	07	0.061	0.50	1.94	10.20	2.50	3.06	3.54	4.33	5.30
055	602	501	502	503	504	●	00	07	0.063	0.55	2.13	11.22	2.75	3.37	3.89	4.76	5.83
06	602	521	522	523	524	●	00	07	0.068	0.60	2.32	12.24	3.00	3.67	4.24	5.20	6.36
065	602	531	532	533	534	●	00	07	0.069	0.65	2.52	13.26	3.25	3.98	4.60	5.63	6.89
07	602	541	542	543	544	●	00	07	0.071	0.70	2.71	14.28	3.50	4.29	4.95	6.06	7.42
075	602	551	552	553	554	●	00	07	0.075	0.75	2.90	15.29	3.75	4.59	5.30	6.49	7.95
08	602	571	572	573	574	●	00	07	0.080	0.80	3.10	16.31	4.00	4.90	5.66	6.93	8.49
087	602	581	582	583	584	●	00	07	0.081	0.87	3.37	17.74	4.35	5.33	6.15	7.53	9.23
09	602	591	592	593	594	●	00	07	0.083	0.90	3.49	18.35	4.50	5.51	6.37	7.80	9.55
10	602	601	602	603	604	●	00	07	0.091	1.00	3.87	20.38	5.00	6.12	7.07	8.66	10.60
11	602	621	622	623	624	●	00	07	0.094	1.10	4.26	22.42	5.50	6.74	7.78	9.53	11.67
125	602	641	642	643	644	●	00	07	0.098	1.25	4.84	25.48	6.25	7.65	8.84	10.83	13.26
131	602	651	652	653	654	●	00	07	0.100	1.31	5.07	26.71	6.55	8.02	9.27	11.35	13.90
139	602	661	662	663	664	●	00	07	0.104	1.39	5.38	28.34	6.95	8.51	9.83	12.04	14.74
15	602	671	672	673	674	●	00	07	0.106	1.50	5.81	30.58	7.50	9.18	10.60	12.99	15.91
175	602	701	702	703	704	●	00	07	0.118	1.75	6.78	35.68	8.75	10.72	12.38	15.16	18.56
20	602			723	724	●	00	07	0.120	2.00	7.75	40.78	10.00	12.25	14.14	17.32	21.21
25	602			763	764	●	00	07	0.138	2.50	9.68	50.97	12.50	15.31	17.68	21.65	26.52
30	602			793		●	00	07	0.153	3.00	11.62	61.16	15.00	18.37	21.21	25.98	31.82

Conversion formula for this series: $\dot{V}_2 = \dot{V}_1 \cdot \sqrt{\frac{P_2}{P_1}}$



Assembly accessories can be found in Chapter 12 "Accessories".

Ordering example: 602 + 361 + A3 + 00 = Ordering no. = 602.361.A3.00