



# Flat fan nozzles

## Series 621





### Parabolic distribution of liquid.

#### Applications:

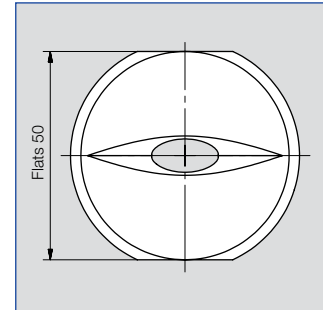
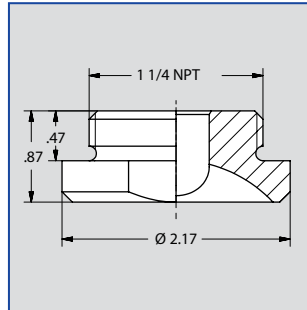
Cleaning, pickling, surface treatment, rinsing.



Spray angle 	Ordering no.		Equivalent Orifice diam. [in]	Free passage [in]	Flow Rate (Gallons Per Minute)								Spray width B at p=30 psi 	
	Type	Mat. no.			10 psi		20 psi		liters per minute		100 psi		H=10"	H=20"
		5E			2 bar	40 psi	60 psi	80 psi	100 psi					
20°	<b>621. 121</b>	○	.315	.256	9.8	13.8	63	19.5	23.9	27.6	30.9	5	8	
45°	<b>621. 123</b>	○	.394	.287	9.8	13.8	63	19.5	23.9	27.6	30.9	10	19	
	<b>621. 203</b>	○	.472	.386	15.5	21.9	100	31.0	38.0	43.9	49.1	10	19	
	<b>621. 243</b>	○	.524	.402	19.4	27.4	125	38.8	47.5	54.9	61.3	10	19	
	<b>621. 263</b>	○	.559	.417	21.7	30.7	140	43.4	53.2	61.4	68.7	10	19	
	<b>621. 283</b>	○	.591	.453	24.8	35.1	160	49.6	60.8	70.2	78.5	10	19	
60°	<b>621. 343</b>	○	.709	.567	34.8	49.1	224	69.5	85.1	98.3	109.9	10	19	
	<b>621. 124</b>	○	.394	.291	9.8	13.8	63	19.5	23.9	27.6	30.9	13	25	
	<b>621. 204</b>	○	.472	.374	15.5	21.9	100	31.0	38.0	43.9	49.1	13	25	
90°	<b>621. 284</b>	○	.591	.370	24.8	35.1	160	49.6	60.8	70.2	78.5	13	25	
	<b>621. 126</b>	○	.394	.256	9.8	13.8	63	19.5	23.9	27.6	30.9	21	40	
	<b>621. 206</b>	○	.472	.343	15.5	21.9	100	31.0	38.0	43.9	49.1	21	40	
	<b>621. 286</b>	○	.591	.470	24.8	35.1	160	49.6	60.8	70.2	78.5	21	40	

incl. gasket 062.140.72.00 (Material: EWP 210)

<b>Example</b>	<b>Type</b>	<b>+</b>	<b>Material no.</b>	<b>=</b>	<b>Ordering no.</b>
<b>of ordering:</b>	<b>621. 121</b>	<b>+</b>	<b>5E</b>	<b>=</b>	<b>621. 121. 5E</b>