

Oval full cone nozzle

Series 400.291

Series 400.291

Oval full cone spray pattern
90° x 60°

Applications:

Single and multi nozzle arrangements in segments for water only secondary cooling in bloom and slab casters. Ideal for foot roller spray positions in order to prevent mould edge erosion by replacing flat fan nozzles. Also suitable for vertical spray positions such as narrow side cooling in slab casters or vertical spray cooling in bloom casters.



Series 400.291

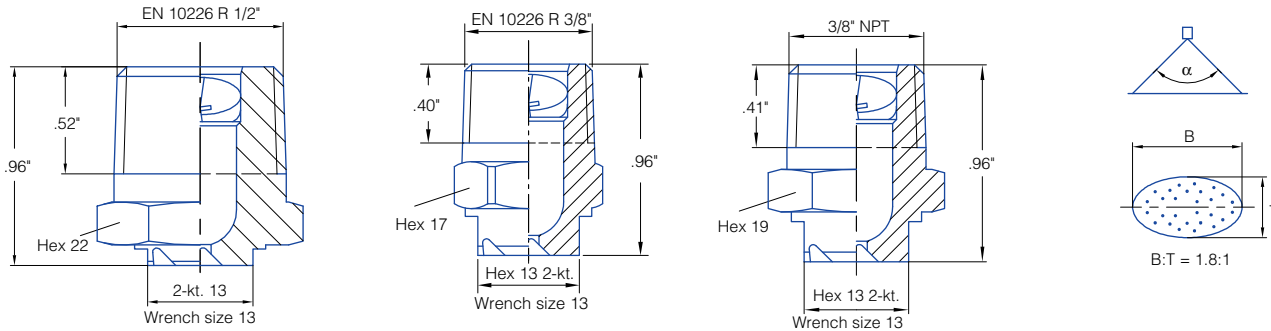

Ordering no.	Thread				Narrowest cross section (in.)	Flow Rate (Gallons Per Minute)					
	3/8 NPT	R 1/2"	R 3/8"	R 3/8" secured		10 psi	20 psi	liters per minute 2 bar	40 psi	80 psi	100 psi
400. 291. 30. X6	○	-	○	○	.04	0.32	0.44	2.00	0.61	0.85	0.95
400. 291. 30. X4	○	-	○	○	.05	0.43	0.60	2.70	0.83	1.15	1.28
400. 291. 30. X5	○	○	○	○	.06	0.54	0.75	3.40	1.04	1.45	1.61
400. 291. 30. X0	○	○	○	○	.07	0.70	0.98	4.40	1.35	1.87	2.08
400. 291. 30. X1	○	-	○	-	.08	0.95	1.31	5.90	1.81	2.51	2.79
400. 291. 30. X2	○	-	○	-	.08	1.09	1.51	6.80	2.09	2.89	3.21
400. 291. 30. X7	-	-	○	-	.13	2.56	3.55	16.00	4.92	6.81	7.56

Materials: 30 (Brass), 16 (stainless steel) on request.
Other nozzle types on request.
Pressure-flow diagrams on request.

3/8 NPT: X=1
R 1/2: X=7
R 3/8: X=0
3/8 NPT secured: X=5

To complete the final ordering no., please replace "X" by the corresponding NPT / R value.

Conversion formula for the above series: $V_2 = V_1 \sqrt{\frac{P_2}{P_1}}$