

➤ Pneumatic atomizing nozzles, wide full cone, pressure principle, internal mixing

Series 136.2



Features:

- Fine full cone atomization
- Liquid pressure principle
- Internal mixing
- Extra wide spray angle of 60°

Applications:

- Humidification
- Cooling

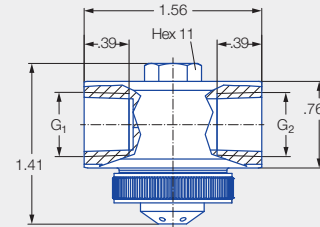

Series 136.2

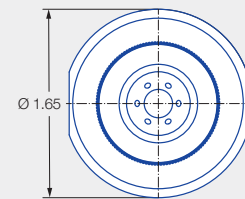
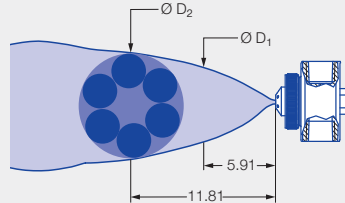

Liquid connection G ₁	Air connection G ₂	Screw plug thread (size 11)	Weight [lb] (Stainless steel 303)
1/4 NPT	1/4 NPT	5/16-24 UNF-2A	0.5

Spray angle	Ordering number			Narrowest free cross section Ø [in]	Liquid pressure p [psi]												Spray dimensions							
	Type	Material number			10				20				40				60				p air [psi]	p water [psi]	Ø D ₁ [in]	Ø D ₂ [in]
		1Y	16		p air [psi]	V̇ water [gal/h]	V̇ air [SCFM]	p air [psi]	V̇ water [gal/h]	V̇ air [SCFM]	p air [psi]	V̇ water [gal/h]	V̇ air [SCFM]	p air [psi]	V̇ water [gal/h]	V̇ air [SCFM]								
60°	136.215.xx.B2	●	●	0.02	15	0.8	0.8	23	1.5	1.0	41	2.2	1.4	55	2.5	1.8	15	10	8	13				
					17	0.5	0.9	26	1.3	1.1	46	1.9	1.6	61	2.2	2.1	23	22	9	15				
					20	0.2	1.1	29	1.0	1.2	52	1.5	1.9	67	1.8	2.3	35	29	9	15				
					-	-	-	32	0.7	1.4	58	1.1	2.1	73	1.4	2.5	46	44	10	15				
					-	-	-	35	0.4	1.5	64	0.6	2.4	78	1.0	2.8	61	58	10	16				
					-	-	-	38	0.2	1.6	70	0.2	2.6	84	0.6	3.1	-	-	-	-				
					-	-	-	-	-	-	73	0.1	2.7	87	0.4	3.3	-	-	-	-				
					-	-	-	-	-	-	-	-	-	-	-	-	-	-	-	-				
	136.222.xx.B2	●	●	0.04	12	4.6	1.6	23	6.8	2.4	44	10.7	3.4	55	14.5	3.8	12	10	10	18				
					15	1.6	2.5	26	3.9	3.1	46	8.3	4.1	58	12.0	4.3	23	22	10	18				
					-	-	-	29	1.8	3.9	49	5.9	4.8	61	9.9	5.0	33	29	10	18				
					-	-	-	32	0.5	4.8	52	3.9	5.6	64	7.8	5.7	46	44	10	18				
					-	-	-	-	-	-	55	2.2	6.5	67	5.7	6.6	61	58	10	18				
					-	-	-	-	-	-	58	1.2	7.2	70	4.0	7.3	-	-	-	-				
					-	-	-	-	-	-	-	-	-	73	2.6	8.1	-	-	-	-				
					-	-	-	-	-	-	-	-	-	75	1.6	8.9	-	-	-	-				
	136.231.xx.B2	●	●	0.06	23	6.8	3.0	38	11.7	4.1	52	24.8	4.6	61	35.1	4.3	29	10	9	15				
					29	4.7	3.6	44	8.7	4.8	58	20.7	5.5	67	31.0	5.3	38	22	10	16				
					35	3.0	4.2	49	6.5	5.4	64	17.4	6.2	73	26.7	6.1	35	29	10	17				
					41	1.8	4.8	55	4.8	6.0	70	14.5	7.0	78	23.2	6.9	52	44	10	17				
					-	-	-	61	3.5	6.6	75	12.0	7.7	84	20.2	7.8	61	58	10	17				
					-	-	-	67	2.5	7.1	81	10.0	8.3	87	18.8	8.1	-	-	-	-				
					-	-	-	-	-	-	87	9.5	8.5	-	-	-	-	-	-	-				
					-	-	-	-	-	-	-	-	-	-	-	-	-	-	-	-				

Ordering Type + Material no. = Ordering no.
 example: 136.215.xx.B2 + 1Y = 136.215.1Y.B2



➤ Pneumatic atomizing nozzles, wide full cone, pressure principle, internal mixing

Series 166.2

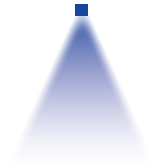

Features:

- Version with magnetic valve
- Fine full cone atomization
- Pressure principle
- Internal mixing
- Extra wide spray angle of 60°

Applications:

- Humidification of air
- Cooling

Technical data:

- Operating pressure: 0–87 psi
- Voltage: 24 V DC
- Power: 8 W
- Switching frequency: Approx. 500/min
- Protective system: IP 67
- Ambient temperature: +50 °C / +122 °F
- Cable length: 39.37 in
- Material of gasket: EPDM



Series 166.2

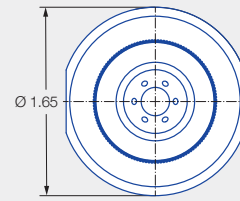
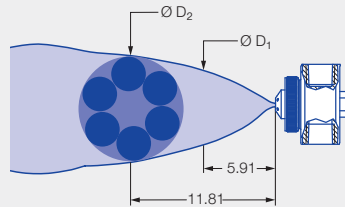
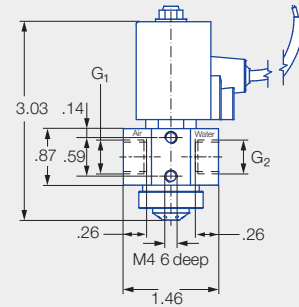

Air connection G ₁	Water connection G ₂	Weight [lb]
1/4 NPT	1/4 NPT	0.90

Spray angle	Ordering number		Narrowest free cross section Ø [in]	Liquid pressure p [psi]												Spray dimensions						
	Type	Material number		10				20				40				60				p water [psi]	Ø D ₁ [in]	Ø D ₂ [in]
		16		p air [psi]	v̇ water [gal/h]	v̇ air [SCFM]	p air [psi]	v̇ water [gal/h]	v̇ air [SCFM]	p air [psi]	v̇ water [gal/h]	v̇ air [SCFM]	p air [psi]	v̇ water [gal/h]	v̇ air [SCFM]							
60°	166.215.xx.B2	●	0.02	15	0.8	0.8	23	1.5	1.0	41	2.2	1.4	55	2.5	1.8	15	10	8	330			
				17	0.5	0.9	26	1.3	1.1	46	1.9	1.6	61	2.2	2.1	23	22	9	380			
				20	0.2	1.1	29	1.0	1.2	52	1.5	1.9	67	1.8	2.3	35	29	9	385			
				-	-	-	32	0.7	1.4	58	1.1	2.1	73	1.4	2.5	46	44	10	390			
				-	-	-	35	0.4	1.5	64	0.6	2.4	78	1.0	2.8	61	58	10	410			
				-	-	-	38	0.2	1.6	70	0.2	2.6	84	0.6	3.1	-	-	-	-			
				-	-	-	-	-	-	73	0.1	2.7	87	0.4	3.3	-	-	-	-			
				-	-	-	-	-	-	-	-	-	-	-	-	-	-	-	-			
	166.222.xx.B2	●	0.04	12	4.6	1.6	23	6.8	2.4	44	10.7	3.4	55	14.5	3.8	12	10	10	450			
				15	1.6	2.5	26	3.9	3.1	46	8.3	4.1	58	12.0	4.3	23	22	10	465			
				-	-	-	29	1.8	3.9	49	5.9	4.8	61	9.9	5.0	33	29	10	465			
				-	-	-	32	0.5	4.8	52	3.9	5.6	64	7.8	5.7	46	44	10	465			
				-	-	-	-	-	-	55	2.2	6.5	67	5.7	6.6	61	58	10	465			
				-	-	-	-	-	-	58	1.2	7.2	70	4.0	7.3	-	-	-	-			
				-	-	-	-	-	-	-	-	-	73	2.6	8.1	-	-	-	-			
				-	-	-	-	-	-	-	-	-	75	1.6	8.9	-	-	-	-			
	166.231.xx.B2	●	0.06	23	6.8	3.0	38	11.7	4.1	52	24.8	4.6	61	35.1	4.3	29	10	9	15			
				29	4.7	3.6	44	8.7	4.8	58	20.7	5.5	67	31.0	5.3	38	22	10	16			
				35	3.0	4.2	49	6.5	5.4	64	17.4	6.2	73	26.7	6.1	35	29	10	17			
				41	1.8	4.8	55	4.8	6.0	70	14.5	7.0	78	23.2	6.9	52	44	10	17			
				-	-	-	61	3.5	6.6	75	12.0	7.7	84	20.2	7.8	61	58	10	17			
				-	-	-	67	2.5	7.1	81	10.0	8.3	87	18.8	8.1	-	-	-	-			
				-	-	-	-	-	-	87	9.5	8.5	-	-	-	-	-	-	-			
				-	-	-	-	-	-	-	-	-	-	-	-	-	-	-	-			

Ordering Type + Material no. = Ordering no.
 example: 166.215.xx.B2 + 16 = 166.215.16.B2