

ENGINEERING
YOUR SPRAY SOLUTION



NEW

Now also available in Alloy 22!

▶▶ STATIC SPRAY BALLS

Series 5B2/5B3

GENERAL INDUSTRY

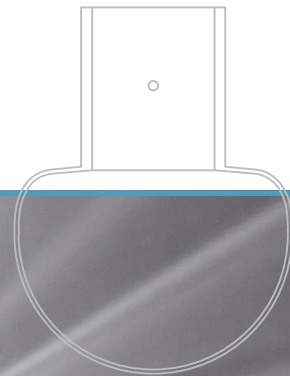

Static spray balls RinseClean Series 5B2/5B3

Features:

- No moving parts
- Self-draining
- Proven use in many applications
- Suitable for very high temperatures and hygienic requirements

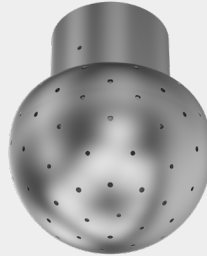

Series 5B2/5B3

Technical data:



Material
Stainless steel 316L,
pin stainless steel 316L,
or Alloy 22, pin Alloy 22



Max. temperature
200 °C



**Recommended
operating pressure**
2 bar



Installation
Operation in every
direction is possible



Max. tank diameter

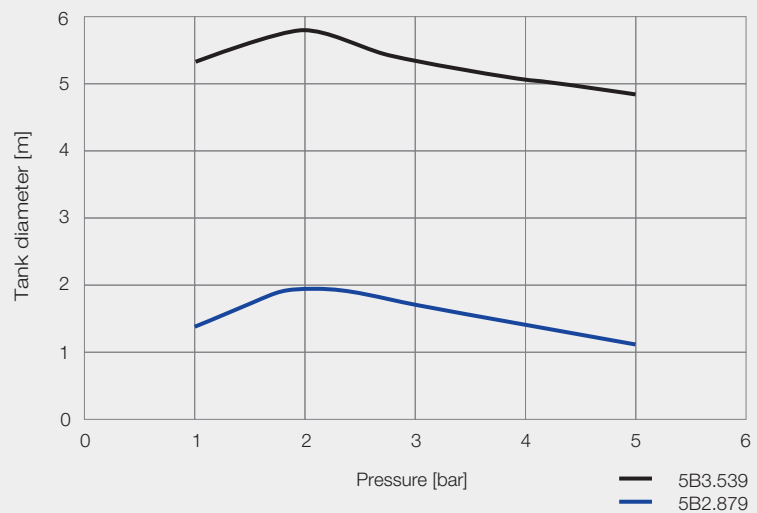

Overview of the tank diameter,
depending upon the pressure of series 5B2/5B3

Connection options

The RinseClean spray ball is available with various slip-on connections, as well as in threaded or welded versions.

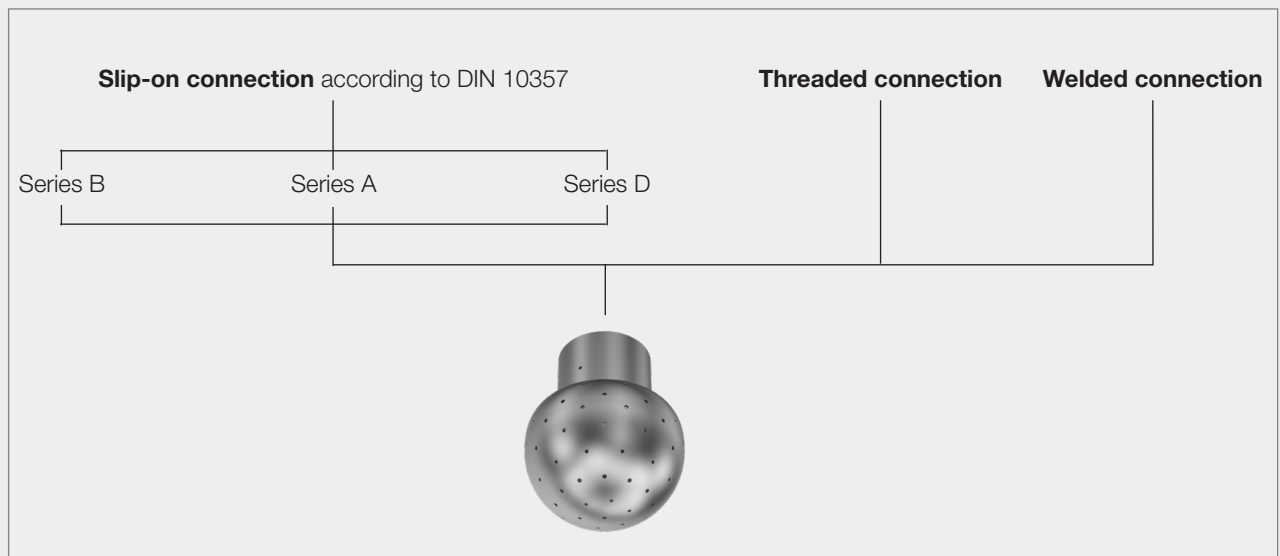

Simply perfect.
Proven technology
in new quality.

RinseClean



Function video
[www.lechler.com/de-en/medialibrary/
videos-general-industry](http://www.lechler.com/de-en/medialibrary/videos-general-industry)
Or scan the QR code.



Slip-on connection

With the slip-on connection, the spray ball is pushed onto the customer's connection pipe and secured with the supplied R-clip. Lechler offers the right connection sizes for the three most common pipe standards.

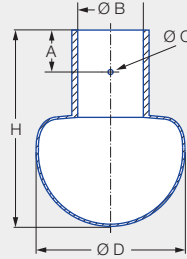

Dimensions slip-on connection according to DIN 10357



Pin 1



Pin 2-5

Pin	Ordering no.	
	1Y	21
	Stainless steel 316L	Alloy 22
1	095.013.1Y.06.55	095.013.21.06.55.0
2	095.013.1Y.06.58	095.013.21.06.58.0
3	095.013.1Y.06.56	095.013.21.06.56.0
4	095.013.1Y.06.59	095.013.21.06.59.0
5	095.013.1Y.06.57	

Information about slip-on connections

- Stainless steel 316L or Alloy 22 pin supplied.
- Depending on the diameter of the adapter, the flow rate can increase due to a leakage between the adapter and the spray ball.

Slip-on connection according to DIN EN 10357, series B (replaces DIN 11850 series 1)

Spray angle	Ordering no.				Narrowest free cross-section Ø [mm]	V̇ water [l/min]				V̇ water at 2 bar [m³/h]	Dimensions [mm]					Pin	Max. tank diameter [m]
	Type	Mat. No.		Connection		p [bar] (p _{max} = 5 bar)					Distance to bore hole A	Connec-tion B	Height H	Ø C	Ø D		
		1Y	21			0.5	1.0	2.0	3.0								
		Stainless steel 316L	Alloy 22														
180° 	5B3.083	●	●	D1.80	1.2	25	35	50	61	3.0	9	18.2	42	2.2	28	1	2.2
	5B3.253	●	●	D2.20	1.8	65	92	130	159	7.8	18	22.2	84	2.2	64	2	3.0
	5B3.323	●	●	D2.80	2.3	100	141	200	245	12.0	18	28.2	84	2.2	64	3	3.5
	5B3.463	●		D5.20	3.3	230	325	460	563	27.6	25	52.3	111	3.0	90	5	5.4
180° 	5B3.114	●	●	D1.80	1.4	30	42	60	74	3.6	9	18.2	42	2.2	28	1	2.2
	5B3.274	●	●	D2.20	2.3	75	106	150	184	9.0	18	22.2	84	2.2	64	2	3.0
	5B3.394	●	●	D2.80	3.0	145	205	290	355	17.4	18	28.2	84	2.2	64	3	5.0
	5B3.444	●		D5.20	3.2	200	283	400	490	24.0	25	52.3	111	3.0	90	5	5.2
270° 	5B3.305	●	●	D2.20	1.9	90	127	180	221	10.8	18	22.2	84	2.2	64	2	3.5
	5B3.345	●	●	D2.80	2.1	115	163	230	282	13.8	18	28.2	84	2.2	64	3	5.0
	5B3.385	●	●	D3.40	2.2	140	198	280	343	16.8	18	34.3	84	2.2	64	4	5.2
	5B3.405	●	●	D3.40	2.4	160	226	320	392	19.2	18	34.3	84	2.2	64	4	5.2
	5B3.425	●	●	D2.80	2.8	180	255	360	441	21.6	18	28.2	84	2.2	64	3	5.2
	5B3.445	●	●	D4.00	2.7	205	290	410	502	24.6	18	40.3	84	2.2	64	4	5.4
	5B3.475	●	●	D3.40	3.1	235	332	470	576	28.2	18	34.3	84	2.2	64	4	5.4
	5B3.535	●		D5.20	3.6	335	474	670	821	40.2	25	52.3	111	3.0	90	5	5.6
	5B3.605	●		D5.20	4.5	500	707	1000	1225	60.0	25	52.3	111	3.0	90	5	5.6

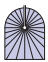
Spray angle	Ordering no.				Narrowest free cross-section Ø [mm]	V̇ water [l/min]				V̇ water at 2 bar [m³/h]	Dimensions [mm]						Pin	Max. tank diameter [m]
	Type	Mat. No.		Connection		p [bar] (p _{max} = 5 bar)					Distance to bore hole A	Con- nection B	Height H	Ø C	Ø D			
		1Y	21			0.5	1.0	2.0	3.0									
		Stainless steel 316L	Alloy 22															
360° 	5B2.879	●	●	D0.80	0.8	8	11	15	18	0.9	9	8.2	37	2.2	20	1	2.0	
	5B3.089	●	●	D1.20	1.0	25	35	50	61	3.0	9	12.2	42	2.2	28	1	2.2	
	5B3.139	●	●	D1.20	1.6	33	46	65	80	3.9	9	12.2	42	2.2	28	1	2.3	
	5B3.209	●	●	D1.80	1.5	50	71	100	123	6.0	9	18.2	42	2.2	28	1	2.5	
	5B3.309	●	●	D2.20	1.7	90	127	180	221	10.8	18	22.2	84	2.2	64	2	3.5	
	5B3.379	●	●	D2.80	2.1	130	184	260	318	15.6	18	28.2	84	2.2	64	3	5.2	
	5B3.389	●	●	D4.00	2.1	140	198	280	343	16.8	18	40.3	84	2.2	64	4	5.2	
	5B3.409	●	●	D3.40	2.3	160	226	320	392	19.2	18	34.2	84	2.2	64	4	5.2	
	5B3.449	●	●	D2.80	3.0	205	290	410	502	24.6	18	28.2	84	2.2	64	3	5.4	
	5B3.489	●	●	D3.40	2.9	255	361	510	625	30.6	18	34.2	84	2.2	64	4	5.5	
	5B3.499	●	●	D4.00	2.8	270	382	540	661	32.4	18	40.3	84	2.2	64	4	5.5	
5B3.539	●	●	D5.20	3.2	335	474	670	821	40.2	25	52.3	111	3.0	90	5	5.6		

The maximum tank diameter applies to the recommended operating pressure and is meant as a recommendation only.
The cleaning result is also affected by the type of soiling.

Slip-on connection according to DIN EN 10357 series A (replaces DIN 11850 series 2)

Spray angle	Ordering no.				Narrowest free cross-section Ø [mm]	V̇ water [l/min]				V̇ water at 2 bar [m³/h]	Dimensions [mm]						Pin	Max. tank diameter [m]
	Type	Mat. No.		Connection		p [bar] (p _{max} = 5 bar)					Distance to bore hole A	Con- nection B	Height H	Ø C	Ø D			
		1Y	21			0.5	1.0	2.0	3.0									
		Stainless steel 316L	Alloy 22															
360° 	5B3.149	●	●	D2.90	0.9	35	50	70	86	22	18	29.2	84	2.2	64	3	2.3	
	5B3.299	●	●	D2.90	1.5	83	117	165	202	52	18	29.2	84	2.2	64	3	3.2	
	5B3.359	●	●	D2.90	1.9	115	163	230	282	72	18	29.2	84	2.2	64	3	5.0	
	5B3.399	●	●	D2.90	2.2	150	212	300	367	94	18	29.2	84	2.2	64	3	5.2	
	5B3.429	●	●	D2.90	2.6	180	255	360	441	112	18	29.2	84	2.2	64	3	5.2	
	5B3.539	●	●	D5.30	3.2	335	474	670	821	208	25	53.3	111	3.0	90	5	5.6	

The maximum tank diameter applies to the recommended operating pressure and is meant as a recommendation only.
The cleaning result is also affected by the type of soiling.

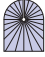

Slip-on connection according to DIN EN 10357 series D (ASME BPE 1997, OD tube compatible)

Spray angle	Ordering no.				Narrowest free cross-section Ø [mm]	V̇ water [l/min]				V̇ water at 2 bar [m³/h]	Dimensions [mm]					Pin	Max. tank diameter [m]
	Type	Mat. No.		Connection		p [bar] (p _{max} = 5 bar)					Distance to bore hole A	Con-nection B	Height H	Ø C	Ø D		
		1Y	21			0.5	1.0	2.0	3.0								
		Stainless steel 316L	Alloy 22														
360° 	5B3.089	●	●	A1.00	1.0	25	35	50	61	16	9	9.8	42	2.2	28	1	2.2
	5B3.209	●	●	A1.90	1.5	50	71	100	123	31	9	19.3	42	2.2	28	1	2.5
	5B3.309	●	●	A1.90	1.7	90	127	180	221	56	18	19.3	84	2.2	64	1	3.5
	5B3.379	●	●	A2.60	2.1	130	184	260	318	81	18	25.6	84	2.2	64	3	5.2
	5B3.449	●	●	A3.80	3.0	205	290	410	502	128	18	38.3	84	2.2	64	4	5.4
	5B3.539	●		A5.10	3.2	335	474	670	821	208	25	51.1	111	3.0	90	5	5.6

The maximum tank diameter applies to the recommended operating pressure and is meant as a recommendation only. The cleaning result is also affected by the type of soiling.

Thread connection

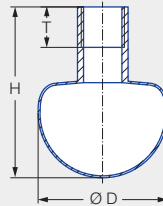

Thread connection

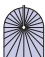
Spray angle	Ordering no.						Narrowest free cross-section Ø [mm]	V̇ water [l/min]				V̇ water at 2 bar [m³/h]	Dimensions [mm]			Max. tank diameter [m]	
	Type	Mat. No.		Connection				p [bar] (p _{max} = 5 bar)					Height H	Screw-in length T	Ø D		
		1Y	21	1/8 BSPP	1/2 BSPP	1 BSPP		2 BSPP	0.5	1.0	2.0						3.0
		Stainless steel 316L	Alloy 22														
360° 	5B2.879	●	●	AA				0.8	8	11	15	18	5	37	8	20	2.0
	5B3.309	●	●		AH			1.9	90	127	180	221	56	84	14	64	3.5
	5B3.379	●	●			AN		2.1	130	184	260	318	81	84	18	64	5.2
	5B3.539	●					AW	3.1	335	474	670	821	208	111	24	90	5.6

The maximum tank diameter applies to the recommended operating pressure and is meant as a recommendation only. The cleaning result is also affected by the type of soiling.

Weld-on connection

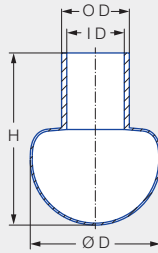

Weld-on connection according to ISO 2037

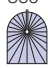
Spray angle	Ordering no.				Narrowest free cross-section Ø [mm]	V̇ water [l/min]				V̇ water at 2 bar [m³/h]	Dimensions [mm]			Max. tank diameter [m]
	Type	Mat. No.		Connection		p [bar] (p _{max} = 5 bar)					Height H	Ø D	Connection piece Outside-Ø/ Inside-Ø	
		1Y	21			0.5	1.0	2.0	3.0					
360° 	5B2.879	●	●	W1.20	0.8	8	11	15	18	4.7	37	20	12.0/10.0	2.0
	5B3.089	●	●	W1.20	1.0	25	35	50	61	15.5	42	28	12.0/10.0	2.2
	5B3.209	●	●	W1.70	1.5	50	71	100	123	31.0	42	28	17.2/15.2	2.5
	5B3.309	●	●	W2.50	1.7	90	127	180	221	55.8	84	64	25.0/22.6	3.5
	5B3.379	●	●	W2.50	2.1	130	184	260	318	80.7	84	64	25.0/22.6	5.2
	5B3.449	●	●	W3.80	3.0	205	290	410	502	127.2	84	64	38.0/35.6	5.4

The maximum tank diameter applies to the recommended operating pressure and is meant as a recommendation only. The cleaning result is also affected by the type of soiling.

**ENGINEERING
YOUR SPRAY SOLUTION**



Lechler GmbH · Precision Nozzles · Nozzle Systems
Ulmer Strasse 128 · 72555 Metzingen, Germany · Phone +49 7123 962-0 · info@lechler.de · www.lechler.com

Edition 04/23 · EN · PDF
Subject to technical modifications or mistakes.