

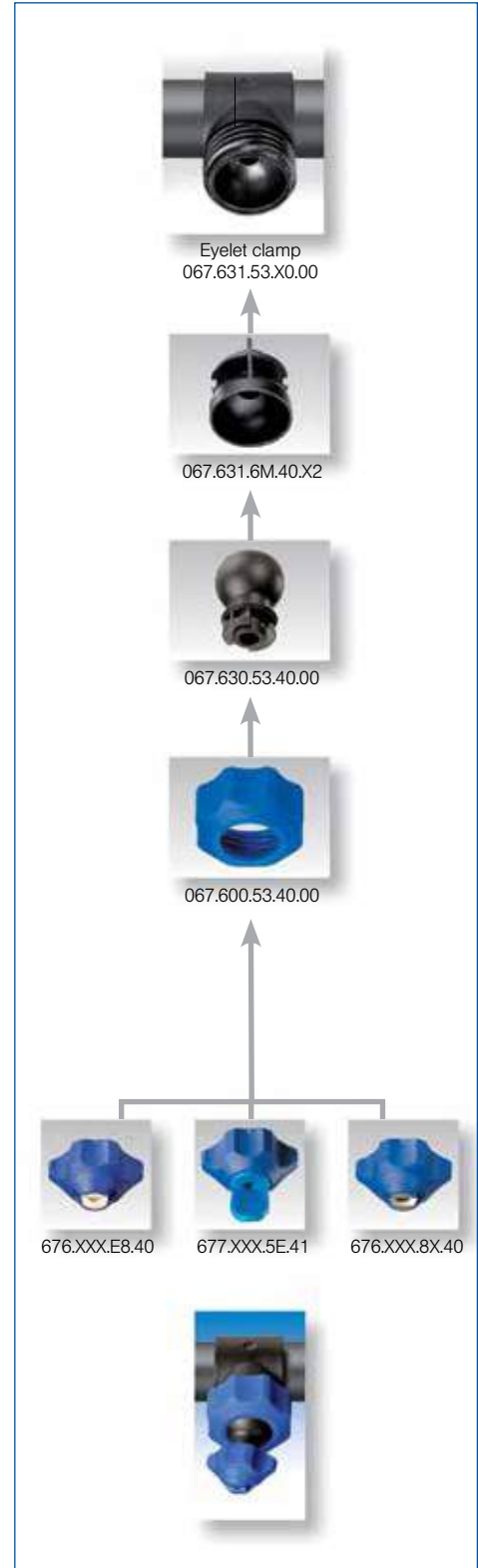

### MEMO SPRAY® / Easy-Clip combination

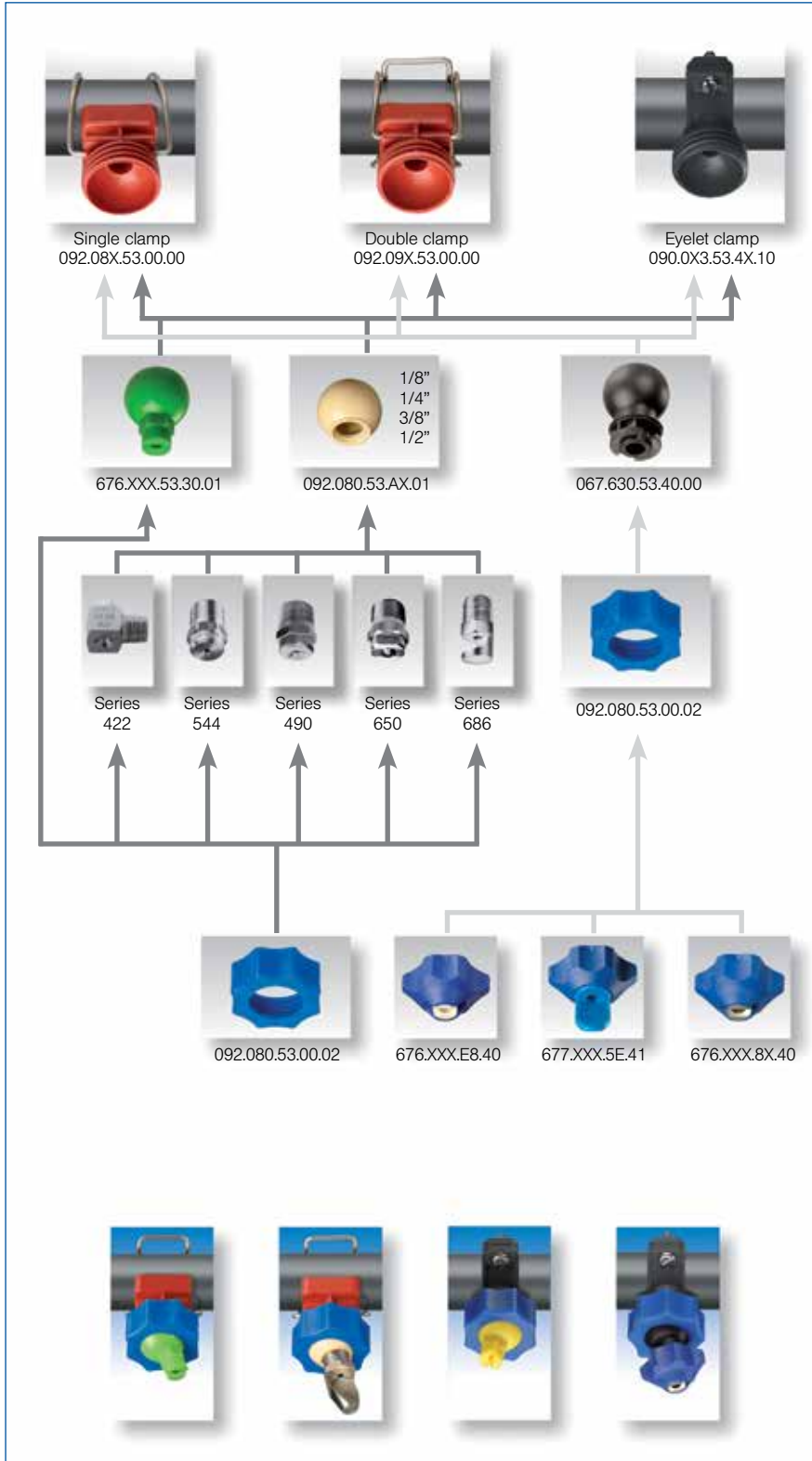



Special pressure-resistant pipe connector, which maintains the adjusted spray direction using the "Memory Method." Easy assembly and maintenance without the need for special tools.

Application:

- Degreasing
- Phosphating in surface treatment
- Cleaning

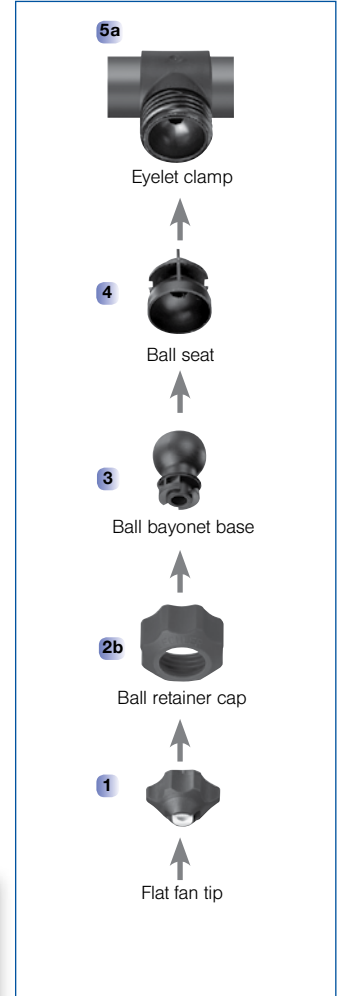
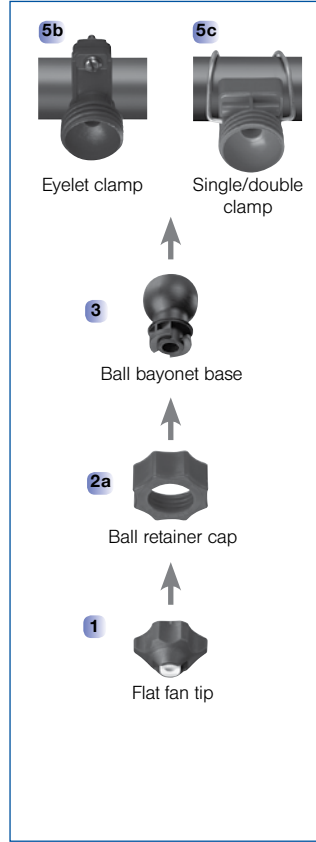
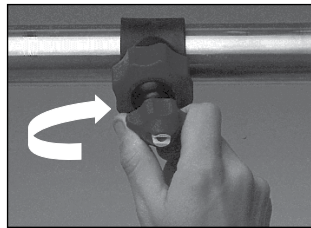
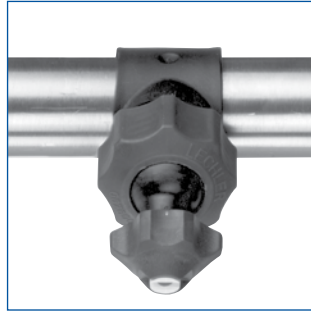

Description	Spray angle	Ordering no.				Orifice diameter	Flow Rate (Gallons Per Minute)							Weight (lb.)				
		Material no.					15 psi	20 psi	2 bar	30 psi	40 psi	60 psi	70 psi	PP/ 303 SS 8F	PP/ 316 L 8R	PP/Ceramic E8	PP 53	
		Housing: PP Insert: 303 SS 8F	Housing: PP Insert: 316 L 8R	Housing: PP Insert: ceramic E8	Polypropylene (PP) 53													
1 Flat fan tip	30°	676. 642. xx. 40	○	○	-	-	.045	.76	.88	4.0	1.1	1.2	1.5	1.6	.03	.03	-	-
		676. 722. xx. 40	○	○	-	-	.059	1.2	1.4	6.3	1.7	2.0	2.4	2.6	.03	.03	-	-
		676. 762. xx. 40	○	○	-	-	.065	1.5	1.8	8.0	2.2	2.5	3.0	3.3	.03	.03	-	-
		676. 802. xx. 40	○	○	-	-	.073	1.9	2.2	10.0	2.7	3.1	3.8	4.1	.03	.03	-	-
		676. 842. xx. 40	○	○	-	-	.085	2.4	2.7	12.5	3.4	3.9	4.8	5.1	.03	.03	-	-
		676. 882. xx. 40	○	○	-	-	.096	3.0	3.5	16.0	4.3	5.0	6.1	6.6	.03	.03	-	-
		676. 922. xx. 40	○	○	-	-	.116	3.8	4.4	20.0	5.4	6.2	7.6	8.2	.03	.03	-	-
		676. 962. xx. 40	○	○	-	-	.119	4.8	5.5	25.0	6.7	7.8	9.5	10.3	.03	.03	-	-
677. 002. xx. 40	○	-	-	-	.133	6.0	6.9	31.5	8.5	9.8	12.0	12.9	.03	-	-	-		
1 Flat fan tip	60°	676. 644. xx. 40	○	○	-	-	.045	.76	.88	4.0	1.1	1.2	1.5	1.6	.03	.03	-	-
		676. 724. xx. 40	○	○	-	-	.059	1.2	1.4	6.3	1.7	2.0	2.4	2.6	.03	.03	-	-
		676. 764. xx. 40	○	○	-	-	.065	1.5	1.8	8.0	2.2	2.5	3.0	3.3	.03	.03	-	-
		676. 804. xx. 40	○	○	-	-	.073	1.9	2.2	10.0	2.7	3.1	3.8	4.1	.03	.03	-	-
		676. 844. xx. 40	○	○	-	-	.085	2.4	2.7	13.0	3.4	3.9	4.8	5.1	.03	.03	-	-
		676. 884. xx. 40	○	○	○	○	.096	3.0	3.5	16.0	4.3	5.0	6.1	6.6	.03	.03	.02	.02
		676. 924. xx. 40	○	○	○	○	.116	3.8	4.4	20.0	5.4	6.2	7.6	8.2	.03	.03	.02	.02
		676. 964. xx. 40	○	○	○	○	.119	4.8	5.5	25.0	6.7	7.8	9.5	10.3	.03	.03	.02	.02
		677. 004. xx. 40	○	○	○	○	.133	6.0	6.9	31.5	8.5	9.8	12.0	12.9	.03	.03	.02	.02
		677. 044. xx. 40	○	○	-	-	.155	7.6	8.8	40.0	10.8	12.4	15.2	16.4	.03	.03	-	-
		677. 084. xx. 40	○	○	-	-	.175	9.5	11.0	50.0	13.4	15.5	19.0	20.5	.03	.03	-	-

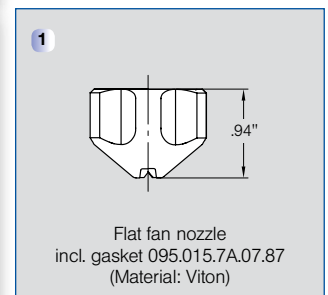

Continued on next page.

Conversion formula for the above series:  $V_2 = V_1 \sqrt{\frac{P_2}{P_1}}$



# Nozzle systems for surface treatment

## MEMO SPRAY®/Easy-Clip



Description	Spray angle	Ordering no.				Orifice diameter	Flow Rate (Gallons Per Minute)							Weight (lb.)				
		Material no.					15 psi	20 psi	2 bar	30 psi	40 psi	60 psi	70 psi	PP/ 303 SS	PP/ 316 L	PP/Ceramic	PP	
		Housing: PP Insert: 303 SS <b>8F</b>	Housing: PP Insert: 316 L <b>8R</b>	Housing: PP Insert: ceramic <b>E8</b>	Polypropylene (PP) <b>53</b>													liters per minute
<b>1</b> Flat fan tip	90°	676. 646. xx. 40	○	○	-	-	.045	.76	.88	4.0	1.1	1.2	1.5	1.6	.03	.03	-	-
		676. 726. xx. 40	○	○	-	-	.059	1.2	1.4	6.3	1.7	2.0	2.4	2.6	.03	.03	-	-
		676. 766. xx. 40	○	○	-	-	.065	1.5	1.8	8.0	2.2	2.5	3.0	3.3	.03	.03	-	-
		676. 806. xx. 40	○	○	-	-	.073	1.9	2.2	10.0	2.7	3.1	3.8	4.1	.03	.03	-	-
		676. 846. xx. 40	○	○	-	-	.085	2.4	2.7	12.5	3.4	3.9	4.8	5.1	.03	.03	-	-
		676. 886. xx. 40	○	○	-	-	.096	3.0	3.5	16.0	4.3	5.0	6.1	6.6	.03	.03	-	-
		676. 926. xx. 40	○	○	-	-	.116	3.8	4.4	20.0	5.4	6.2	7.6	8.2	.03	.03	-	-
676. 966. xx. 40	○	○	-	-	.119	4.8	5.5	25.0	6.7	7.8	9.5	10.3	.03	.03	-	-		
<b>1</b> Flat fan tip	120°	676. 647. xx. 40	○	○	-	-	.045	.76	.88	4.0	1.1	1.2	1.5	1.6	.03	.03	-	-
		676. 727. xx. 40	○	○	-	-	.059	1.2	1.4	6.3	1.7	2.0	2.4	2.6	.03	.03	-	-
		676. 767. xx. 40	○	○	-	-	.065	1.5	1.8	8.0	2.2	2.5	3.0	3.3	.03	.03	-	-
		676. 807. xx. 40	○	○	-	-	.073	1.9	2.2	10.0	2.7	3.1	3.8	4.1	.03	.03	-	-
		676. 847. xx. 40	○	○	-	-	.085	2.4	2.7	12.5	3.4	3.9	4.8	5.1	.03	.03	-	-
		676. 887. xx. 40	○	○	-	-	.096	3.0	3.5	16.0	4.3	5.0	6.1	6.6	.03	.03	-	-
		676. 927. xx. 40	○	○	-	-	.116	3.8	4.4	20.0	5.4	6.2	7.6	8.2	.03	.03	-	-

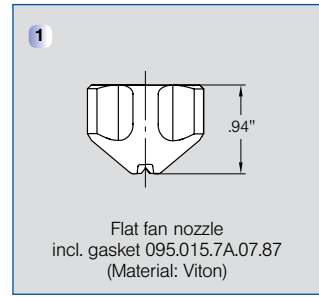

Description	Spray angle	Ordering no.		Orifice diameter	Flow Rate (Gallons Per Minute)							Weight (lb.)				
		Material no.			15 psi	20 psi	2 bar	30 psi	40 psi	60 psi	70 psi	PP/ 303 SS	PP/ 316 L	PP/Ceramic	PP	
		Housing: PP Insert: 316 L <b>8R</b>	PVDF <b>5E</b>													liters per minute
<b>1a</b> Tongue-type nozzle	70°	677. 005. xx. 41	○	-	.169	6.0	6.9	32	8.5	9.8	12.0	12.9	-	.05	.02	-

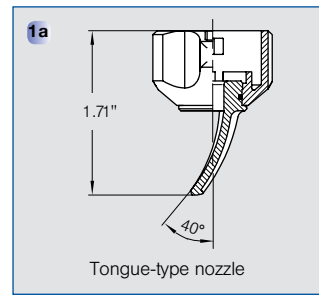

**Example**      **Type**            +   **Material no.**    =   **Ordering no.**  
**for Ordering:** 676. 646. xx. 40 + 8F                    =   **676. 646. 8F. 40**



# Nozzle systems for surface treatment

MEMO SPRAY®/Easy-Clip



Description	Ordering no.	Material no.				Drill Size	For pipe-Ø
		Polypropylene (PP)	PP reinforced				
		<b>53</b>	<b>6M</b>				
<b>2</b> Ball retainer cap	092.080.xx.00.02	○	-				
<b>3a</b> Ball retainer cap	067.600.xx.40	○	-				
<b>3b</b> Ball bayonet base	067.630.xx.40	○	-				
<b>4</b> Ball seat for ball retainer cap no.	067.631.xx.40.22	-	○		.562"	1-1/4"	
<b>5</b>	067.631.xx.40.02	-	○		.625"	1-1/4"	
	067.631.xx.40.00.0	-	○		.781"	1-1/4"	
	067.631.xx.50.22	-	○		.562"	1-1/2"	
	067.631.xx.50.02	-	○		.625"	1-1/2"	
	067.631.xx.50.00.0	-	○		.781"	1-1/2"	
<b>6a</b> Eyelet clamp	067.631.xx.40.00	○	-		-	1-1/4"	
	067.631.xx.50.00	○	-		-	1-1/2"	
<b>6b</b> Eyelet clamp	090.023.xx.44.10	○	-		.562"	1"	
	090.023.xx.43.10	○	-		.625"	1"	
	090.033.xx.44.10	○	-		.562"	1-1/4"	
	090.033.xx.43.10	○	-		.625"	1-1/4"	
	090.033.xx.40.10	○	-		.797"	1-1/4"	
	090.043.xx.44.10	○	-		.562"	1-1/2"	
	090.043.xx.43.10	○	-		.625"	1-1/2"	
	090.043.xx.40.10	○	-		.797"	1-1/2"	
<b>6c</b> Single clamp*	092.080.xx.00	○	-		.625"	1"	
	092.081.xx.00	○	-		.625"	1-1/4"	
	092.082.xx.00	○	-		.625"	1-1/2"	
	092.083.xx.00	○	-		.625"	2"	

\* Other drill sizes on request

**Example**    **Type**                    +    **Material-no.**    =    **Ordering no.**  
 for ordering: 092.080.xx.00.02 + 53                    =    092.080.53.00.02

