

Low pressure flat fan nozzles

Press-in nozzle

Series 612.xxx.5E.03

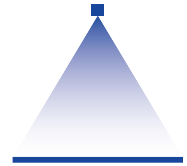

Features:

- Uniform, parabolic liquid distribution
- For pressing into pipes

Applications:

- Cleaning and rinsing procedures
- Industrial dish washers



Series 612.xxx.5E.03

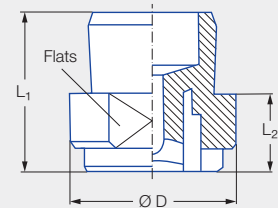

Dimensions [in]				Weight [g]
L ₁	L ₂	Ø D	Flats (mm)	
.49	.22	.55	12	.004

Spray angle	Ordering number		Equivalent bore diameter A [in]	Narrowest free cross section Ø [in]	V̇ water [gal/min]							Spray width B [in] (at p = 30 psi)						
	Type	Material number			p [psi]													
		5E.03			4	7	10	15	22	30	liters per minute			H = 10 [in]	H = 20 [in]			
		PDF																
90°	612.366	●	0.04	0.20	0.06	0.08	0.10	0.12	0.14	0.17	0.63	14	29					
	612.486	●	0.06	0.203	0.16	0.21	0.25	0.30	0.37	0.43	1.60	14	29					
120°	612.487	●	0.06	0.203	0.16	0.21	0.25	0.30	0.37	0.43	1.60	28	50					
	612.647	●	0.10	0.50	0.40	0.52	0.62	0.76	0.92	1.08	4.00	28	50					

Assembly :

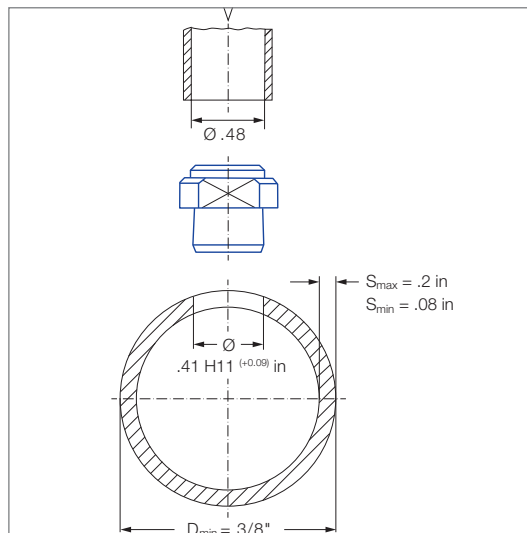

Drill pipe (Ø .4 in), ream to Ø .4 H11 (+0.09) in, adjust nozzle, place press-in pipe (inner diameter .48 in) on nozzle and tap in using a rubber mallet. Max. flow velocity in the pipe 2–3 m/s.

Conversion formula for this series: $\dot{V}_2 = \dot{V}_1 \cdot \sqrt{\frac{p_2}{p_1}}$

Ordering Type + Material no. = Ordering no.
example: 612.366 + 5E.03 = 612.366.5E.03



Assembly accessories can be found in Chapter 12 "Accessories".