

Flat fan dovetail nozzles

Series 660

The 660 series nozzles come with the conventional, automatic self aligning dovetail connection which ensures that every nozzle will always be installed under the correct spray offset angle towards the roll center line.

The small tip dimensions make this nozzle series ideal for roll cooling and strip cooling headers when space is limited especially in small rolling mills for non ferrous metals.

All tips have an automatically built in 5° offset angle if the welding nipple is welded in line with the centre line of the spray header. Any other offset angle has to be compensated for by welding the nipple under a different angle (minus the 5° inbuilt offset angle).

The spray has a parabolic liquid distribution which is ideal for a multi nozzle header arrangement.

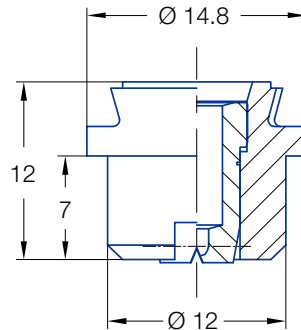
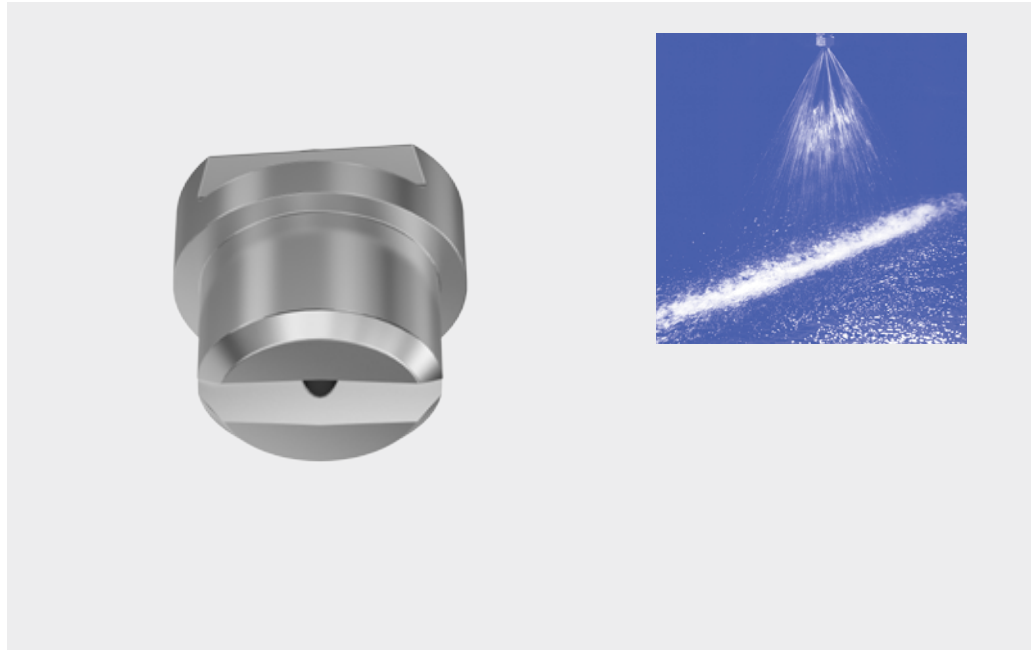

Weight brass: .05 lbs

Accessories

Weight: .14 lbs
 Welding **066.011.17** (316 SS)
 Nipple:

Weight brass .13 lbs
 Retaining nut: **065.200.16** (303 SS)
065.200.17 (316 SS)
065.200.30 (brass)

Other offset angles are available on request

Technical data and ordering data for accessories see page 18.

